



DIESEL FUEL - 10 bar

PAINTED STEEL



In accordance with directive Atex
94/9 HB 2 GD c T4 T135 °C X

FIXED



Supplied with:

- hoses in antistatic black synthetic rubber
- zinc plated steel couplings
- brass swivel joint
- "viton" seals



S. 530

Article

8530.600
8530.603
8530.604

Hose supplied

without hose
12m - 3/4" (997.812)
8m - 1" (998.808)

Connection

inlet

F1"G
F1"G
F1"G

outlet

F1"G
M3/4"G
M1"G

S. 540

8540.100
8540.601
8540.602
8540.603

without hose
15m - 3/4" (997.815)
20m - 3/4" (997.820)
15m - 1" (998.815)

F1"G
F1"G
F1"G
F1"G

F1"G
M3/4"G
M3/4"G
M1"G

S. 560

8560.100
8560.603
8560.604
8560.605

without hose
40m - 3/4" (997.840)
20m - 1" (998.820)
30m - 1" (998.830)

F1"G
F1"G
F1"G
F1"G

F1"G
M3/4"G
M1"G
M1"G

FIXED OVERALL DIMENSIONS

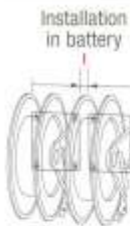
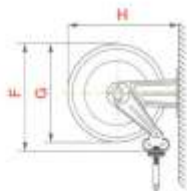
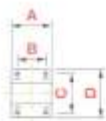

Art.	A	B	C	D	E	F	G	H	I	1-m ³	Kg*
S. 530	203	153	220	258	115	550	510	560	20	0,120	from 19 to 42
S. 540	300	218	228	268	190	550	510	573	0	0,175	from 24 to 40
S. 560	488	399	238	272	368	550	510	578	0	0,310	from 30 to 80

* The list shows min and max weight for each series: min weight refers to version without hose, max weight refers to heaviest version which depends on hose length and diameter.

FIXED HOSE REELS INSTALLATION

The quick coupling support is equipped with 4 slot holes that allow an easy and safe installation of the hose reel. The **template** supplied facilitates drilling of the holes and therefore hose reel fixing.

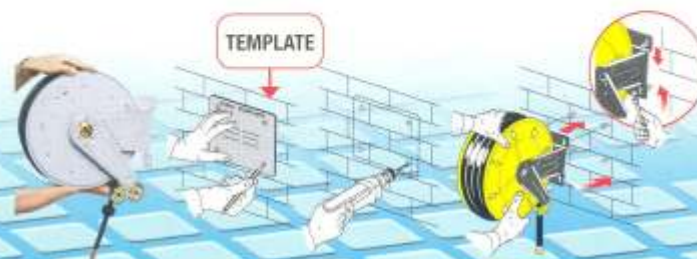

TEMPLATE