

PL koleno s vnějším závitem

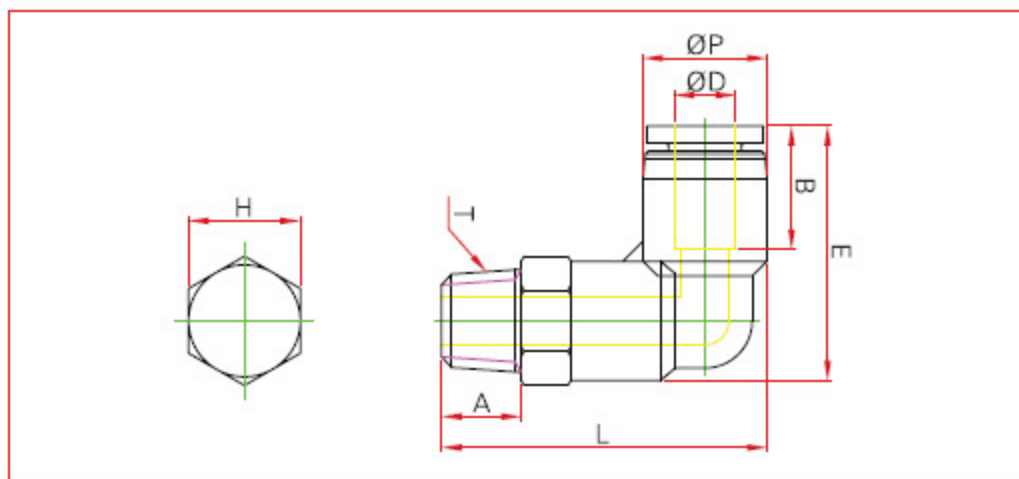

TYP	ØD	T (Závit)	L	E	A	B	H	PRŮTOK
PL04-G01	4	G 1/8	30.3	22.1	5.5	15	14	2.5
PL04-G02	4	G 1/4	32	21.4	7.5	15	17	2.5
PL06-G01	6	G 1/8	32.3	23.2	5.5	15	14	2.5
PL06-G02	6	G 1/4	34.8	23.5	7.5	15	17	4
PL06-G03	6	G 3/8	36.2	20.5	7.5	15	20	4
PL08-G01	8	G 1/8	32.5	25.5	5.5	18	14	4
PL08-G02	8	G 1/4	35.5	24.5	7.5	18	17	4
PL08-G03	8	G 3/8	37.5	21	7.5	18	20	6
PL08-G04	8	G 1/2	40	24.5	10	18	24	6
PL10-G01	10	G 1/8	38.9	29.2	5.5	22	17	6
PL10-G02	10	G 1/4	42.5	30.9	7.5	22	17	6.5
PL10-G03	10	G 3/8	44.1	27.2	7.5	22	20	6.5
PL10-G04	10	G 1/2	46.9	30.4	10	22	24	7.5
PL12-G02	12	G 1/4	44.5	33.5	7.5	22	19	6.5
PL12-G03	12	G 3/8	46.6	28.5	7.5	22	20	7
PL12-G04	12	G 1/2	49.6	31	10	22	24	7.5
PL16-G03	16	G 3/8	55.4	35.5	7.5	24	24	11
PL16-G04	16	G 1/2	60	38	10	24	24	14